

For information about other American International automotive accessories visit our website at:

<http://www.aius.net>

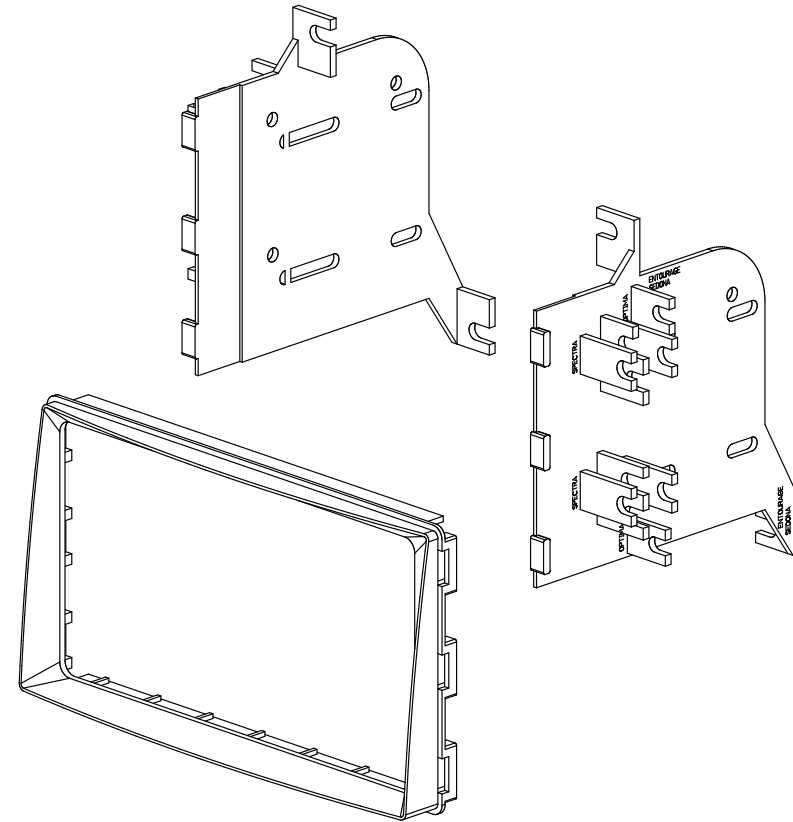

American International
Car Stereo Installation Kits & Accessories



KIAK1248 Mounting Kit



American International

2500 East Francis Street Ontario, CA 91761, U.S.A.
USA Sales (800) 336-6500
Canada Sales (888) 922-3006

VEHICLE APPLICATIONS

- Hyundai**
2007-09 ENTOURAGE
Kia
2006-10 OPTIMA
2007-10 RONDO
2006-14 SEDONA
2004-09 SPECTRA / SPECTRA 5

CUSTOMER HELP LINE

8am-4:30 P.S.T. Monday-Friday Except Holidays

USA 800-323-4329 • Canada 800-245-8777

iKIAK1248

2007-09 HYUNDAI ENTOURAGE
2006-10 KIA SEDONA

DASH DISASSEMBLY

1. Carefully unclip the trim bezel from around the shifter, this trim has the ash tray and 12 volt receptacle attached, disconnect all attached harnesses and set trim aside.
2. Remove the (2) Phillips screws securing the lower edges of the Radio/Vent trim bezel assembly.
3. Carefully unclip and pull forward the radio/Vent trim assembly, disconnect all attached harnesses and remove trim.
4. Remove the (4) Phillips screws securing the climate control module, pull the module forward, and set out of the way.
5. Remove the (4) Phillips screws securing the radio to the sub-dash.
6. Carefully pull radio forward, disconnect all attached harnesses and antenna lead and remove radio.

2006-2010 KIA OPTIMA

DASH DISASSEMBLY

1. Carefully pry forward the Radio/Climate control/Vent trim bezel, disconnect all harnesses from the rear of the bezel and remove bezel.
2. Remove the (4) Phillips screws securing the radio to the sub-dash.
3. Pull radio forward, disconnect the wire harness and antenna lead and remove radio.

2007-09 KIA RONDO

DASH DISASSEMBLY

1. Using a plastic type panel removal tool, carefully pry up on the trim panel from around the shifter knob, disconnect the attached harnesses and remove trim panel
2. Remove the (4) Phillips screws and metal brackets securing the lower edge of the Climate control/Radio trim bezel.
3. Carefully pull the Climate control/Radio trim bezel forward, disconnect all attached harnesses and remove bezel.
4. Remove the (4) Phillip's screws securing the radio to the sub-dash.
5. Carefully pull the radio forward, disconnect all attached harnesses and antenna lead and remove radio.

2005-06 KIA SPECTRA / SPECTRA 5

DASH DISASSEMBLY

1. Using a panel removal tool, carefully pry outward the entire Radio/Climate control trim bezel and disconnect all harnesses attached to the rear of the bezel and remove bezel.
2. Remove the (4) phillips screws securing the radio to the sub-dash.
3. Pull radio forward, disconnect the wire harness, antenna lead, and chassis ground wire and remove radio.

2007-08 KIA SPECTRA / SPECTRA 5

DASH DISASSEMBLY

1. Using a panel removal tool, carefully pry outward the entire Radio/Climate control trim bezel and disconnect all harnesses attached to the rear of the bezel and remove bezel.
2. Remove the (4) phillips screws securing the radio to the sub-dash.
3. Pull radio forward, disconnect the wire harness, antenna lead, and chassis ground wire and remove radio.

NOTES:

BRACKET PREPARATION

2007-08 KIA SPECTRA / SPECTRA 5

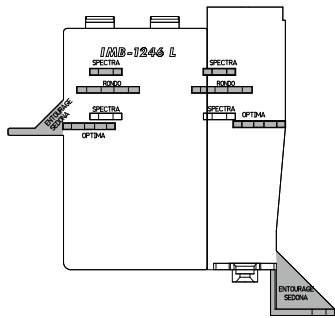

LEFT BRACKET

REMOVE ALL
SHADED TABS ON
L&R BRACKETS

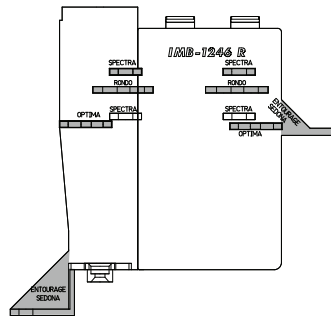

RIGHT BRACKET

2007-09 KIA RONDO

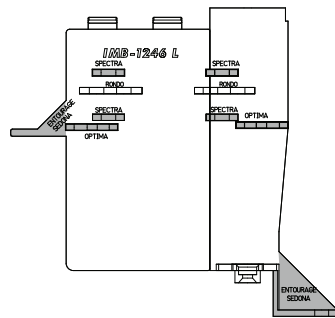

LEFT BRACKET

REMOVE ALL
SHADED TABS ON
L&R BRACKETS

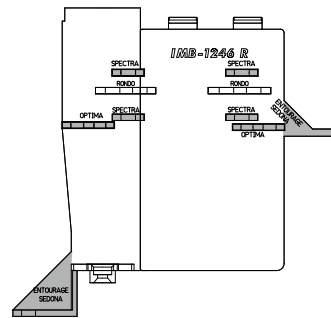

RIGHT BRACKET

KIT ASSEMBLY INSTRUCTIONS

Double DIN Mount Applications

1. Attach the left and right side brackets to the main frame. See Figure A below.
2. Insert ISO mountable radio between ISO mount brackets from the back and loosely attach to sides of radio using screws provided with radio when possible or hardware included with kit.
3. Slide radio component forward or backward for desired look and tighten screws.
4. Attach a rear support bracket to the rear of the new radio and adjust as necessary to attach to the rear support stud located on the back of the pocket using the small phillips screw supplied with kit.

NOTE: Test the movement of the face of the radio prior to securing the kit to the sub-dash, you may need to re-adjust the radio forward for proper clearance.

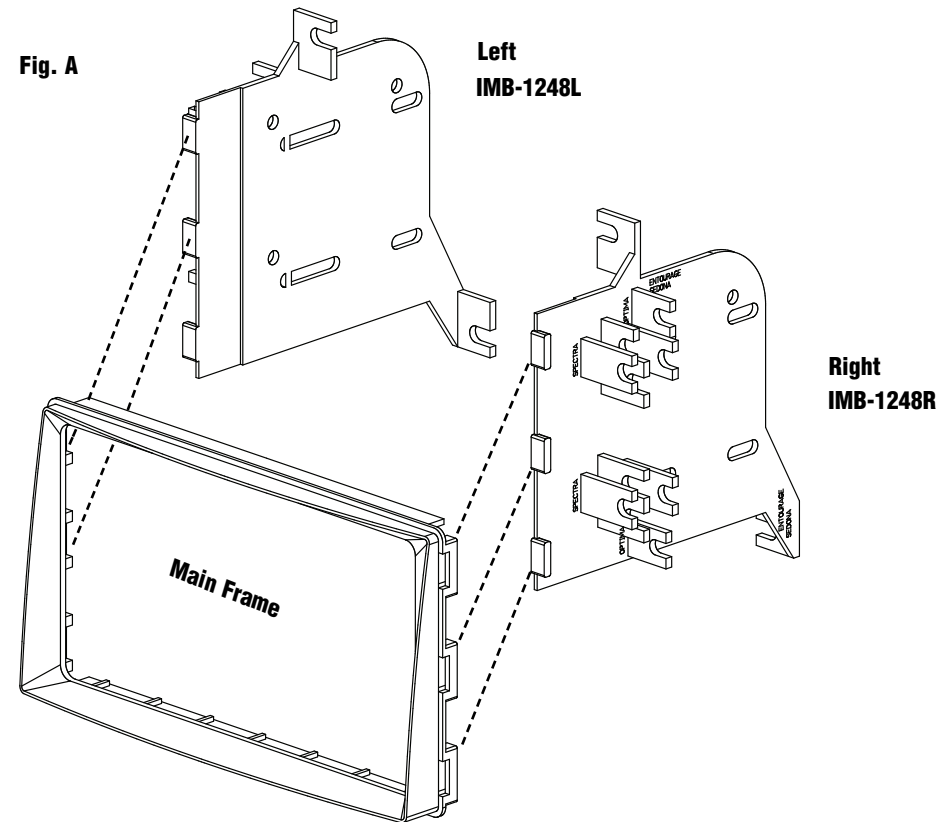

NOTE: For (2) ISO mount components you may need to file the top and bottom edges to allow component(s) faces to move freely.

ISO MOUNT INSTALLATION INSTRUCTIONS

Note: Some radio faces are larger in size than the ITR-1248 Trim Ring allows. You may need to file the Trim Ring opening larger for some radios.

1. See page 5-6 for Bracket Preparation.
2. Attach the left and right side brackets to the main bracket. See illustration below.
3. Attach left and right side brackets to the rear of the pocket using screws supplied w/kit.
4. Attach ISO Mount Spacers to the inside of upper section on both Left & Right mounting brackets as shown in Figure A below.
5. Slide radio into kit from rear & attach to ISO mounting brackets using screws supplied with radio (do not tighten screws at this time). (Be sure the length of the screws DO NOT touch any electrical parts inside radio, some screws may need to be shortened.)
6. Slide radio forward or backward for your desired look and then tighten the mounting screws. Use ISO trim ring when possible.
7. Attach rear support strap (supplied with radio) to rear of pocket and to rear of radio.

NOTE: Optional ISO trim ring (ITR-1248 included) may be used in place of after-market radio's trim ring. For ISO mount applications, mount after-market radio to side brackets using hardware included.

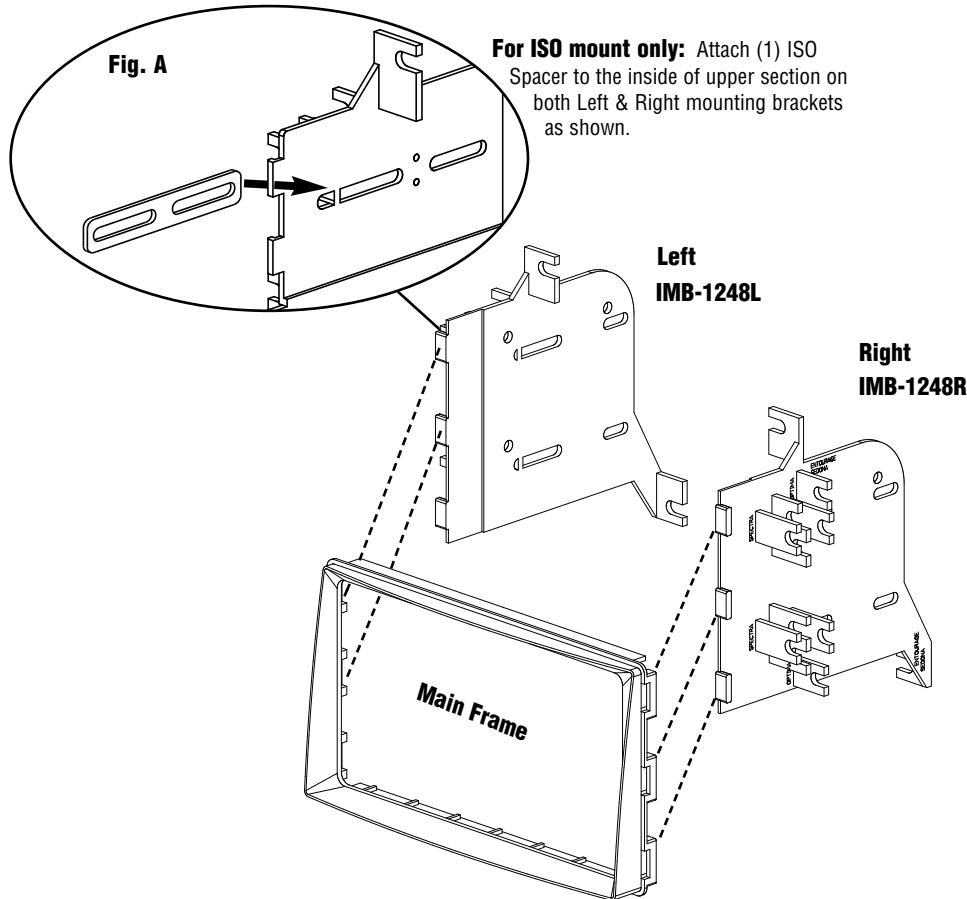

BRACKET PREPARATION

2006-10 KIA OPTIMA

REMOVE ALL SHADED TABS ON L&R BRACKETS

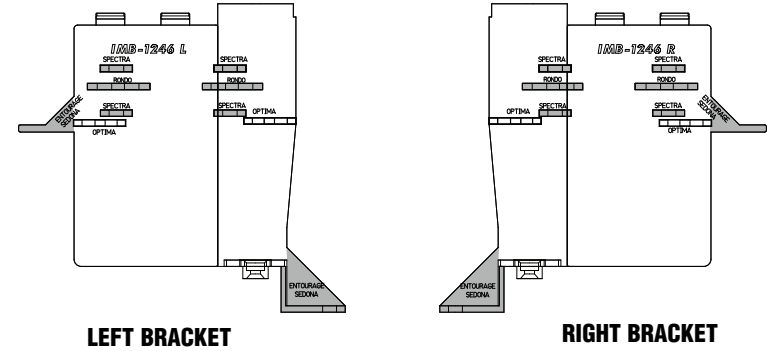

2005-06 KIA SPECTRA / SPECTRA 5

REMOVE ALL SHADED TABS ON L&R BRACKETS

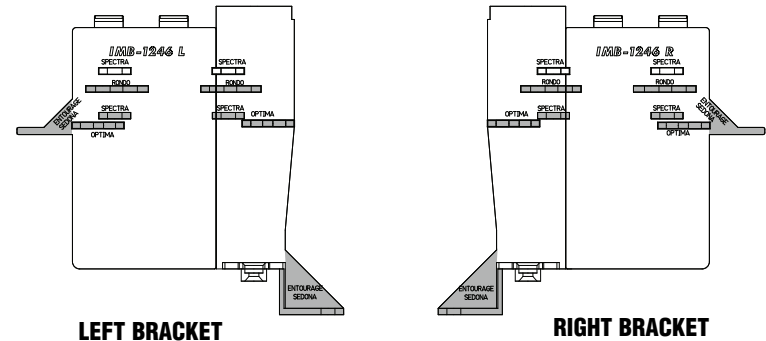

**2007-09 HYUNDAI ENTOURAGE
2006-10 KIA SEDONA**

REMOVE ALL SHADED TABS ON L&R BRACKETS

