

For information about other American International automotive accessories visit our website at:

<http://www.aius.net>

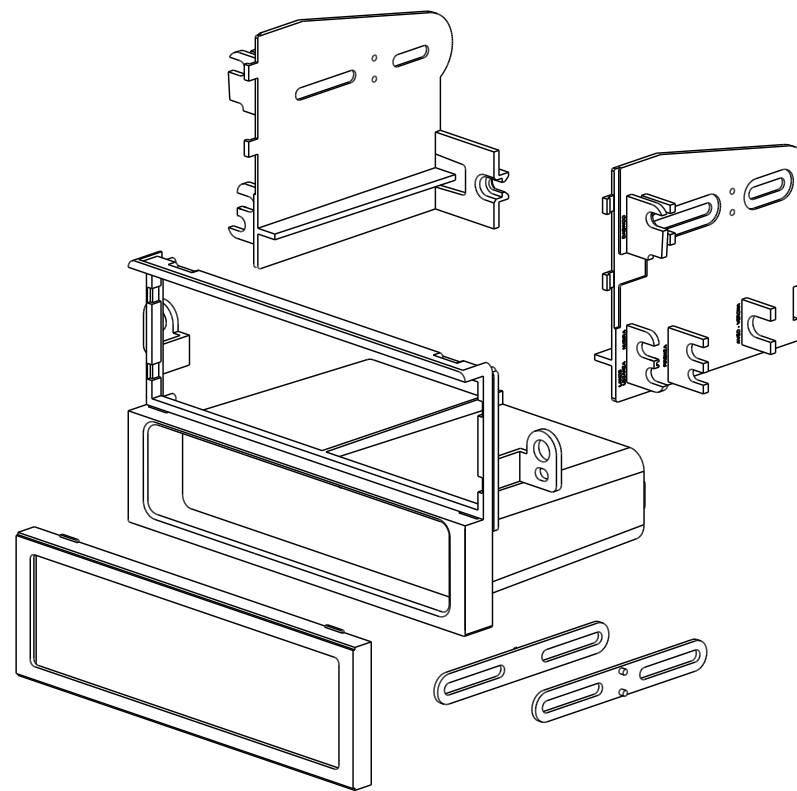

American International
Car Stereo Installation Kits & Accessories



SUZK941 Mounting Kit



American International

2500 East Francis Street Ontario, CA 91761, U.S.A.
USA Sales (800) 336-6500
Canada Sales (888) 922-3006

CUSTOMER HELP LINE
USA 800-323-4329 • Canada 800-245-8777

iSUZK941

VEHICLE APPLICATIONS

Chevrolet

2004-08 AVEO
2004-08 AVEO 5
2004-06 AVEO WAGON

Daewoo

1999-02 LANOS
1999-02 LEGANZA
1999-02 NUBIRA

Suzuki

2004-06 VERONA
2004-08 FORENZA
2005-08 RENO

DIN MOUNT INSTRUCTIONS

1. Attach mounting brackets to rear of kit as shown below and attach to rear of pocket using small screws provided with kit.
2. Insert DIN sleeve from your new radio into the opening of the installation kit.
3. Depress the tabs from inside the sleeves opening upward, outward, and downward to secure sleeve to the installation kit.

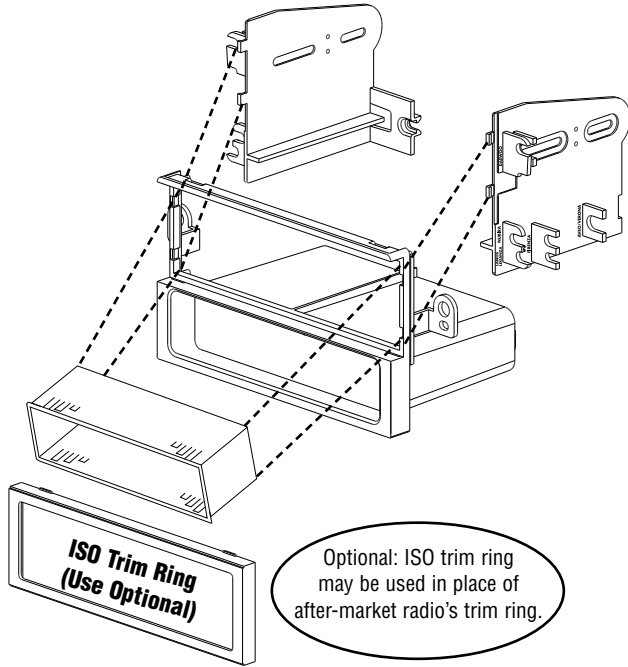

ISO MOUNT INSTRUCTIONS

1. Attach ISO mount brackets to rear of kit as shown below and attach to rear of pocket using small screws provided with kit.
2. Insert ISO mountable radio between ISO mount brackets and loosely attach to sides of radio using screws provided with radio when possible or screws supplied with kit.
3. Attach ISO trim ring to face of kit.
4. Slide radio forward or backward for desired look and tighten screws.

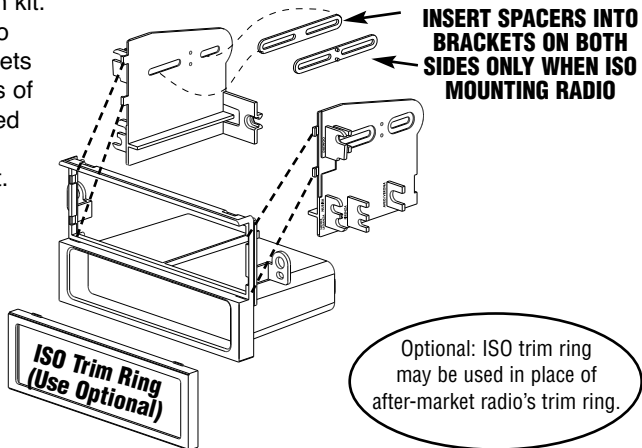

NOTES:

DASH DISASSEMBLY INSTRUCTIONS

1. Carefully unsnap the trim from around the Radio/ Heater A/C controls & remove.
2. Remove the (2) Phillips screws securing the radio to the sub dash.
3. Remove the radio from the dash cavity, disconnect the wire harness & antenna lead & remove the radio.

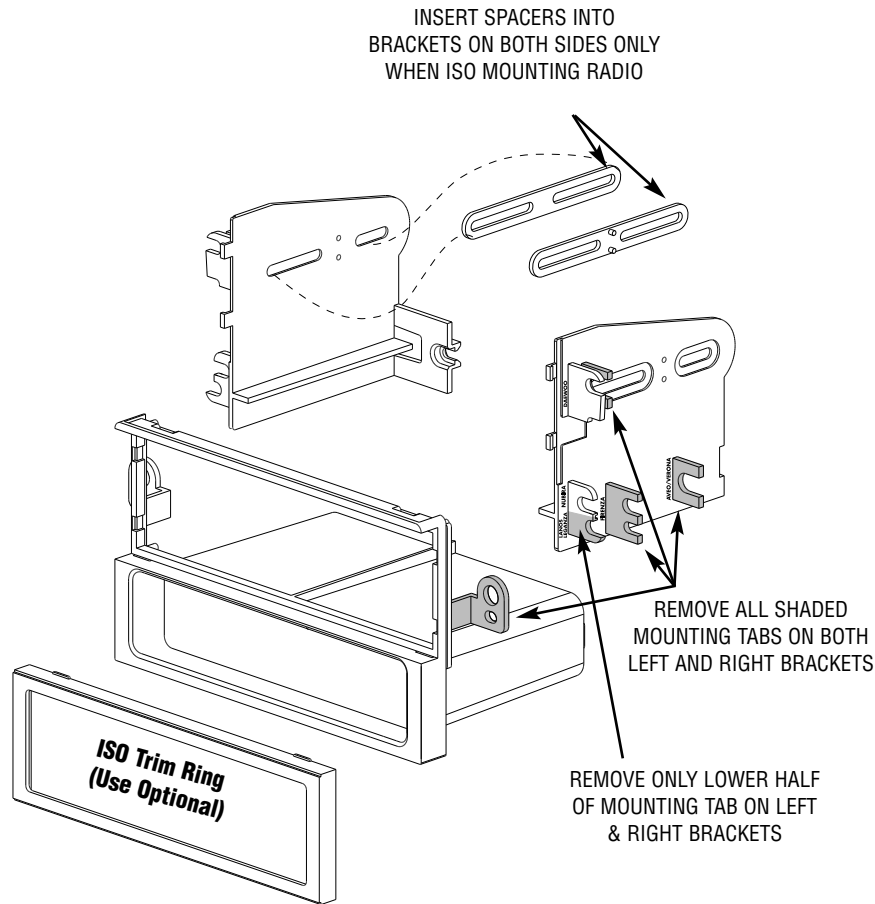

DASH DISASSEMBLY INSTRUCTIONS

1. Starting at the bottom, carefully pry outward and remove the Dash trims from each side of the radio and climate controls.
2. Remove the (4) Phillips screws securing the factory radio to the sub-dash.
3. Carefully pull radio forward, disconnect the wire harness and antenna lead from radio and remove radio.

DASH DISASSEMBLY INSTRUCTIONS

1. Carefully pry radio trim bezel outward to remove.
2. Remove the (4) screws securing the radio to the sub-dash.
3. Pull radio forward, disconnect the wire harness and antenna lead and remove radio.

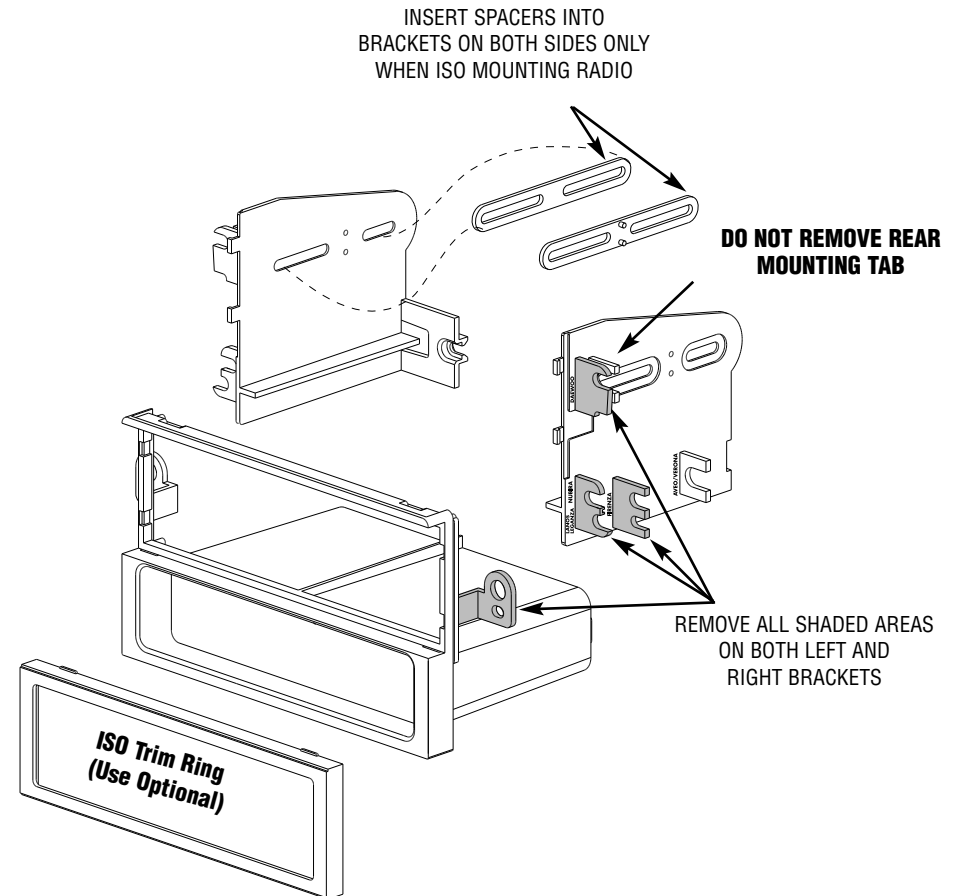

DASH DISASSEMBLY INSTRUCTIONS

1. From below the glove box, remove the (2) phillips screws at the bottom of the glove box.
2. Remove the (3) Phillips screws securing the top of the glove box housing frame and remove glove box assembly.
3. Inside the glove box area on the left is a climate control cable that is attached with a plastic clamp (Be sure you remember how you removed it so you will be able to re-attach it when re-assembling the vehicle). Unfasten the cable clamp and unhook the cable from the Heater control gear.
4. From under the driver's side dash, unfasten the single climate control cable (same removal instructions as in step 3 above).
5. Starting from the bottom of the climate control/dash trim bezel, carefully pry outward to release the (6) trim bezel clips and pull trim bezel forward.
6. Disconnect all harnesses from the rear of the climate controls and trim bezel and remove bezel (Make sure you look to see how the (2) climate control cables were routed for dash re-assembly).
7. Remove the (4) Phillips screws securing the radio or radio & pocket to the sub-dash.
8. Pull radio forward, disconnect the wire harness and antenna lead and remove radio.

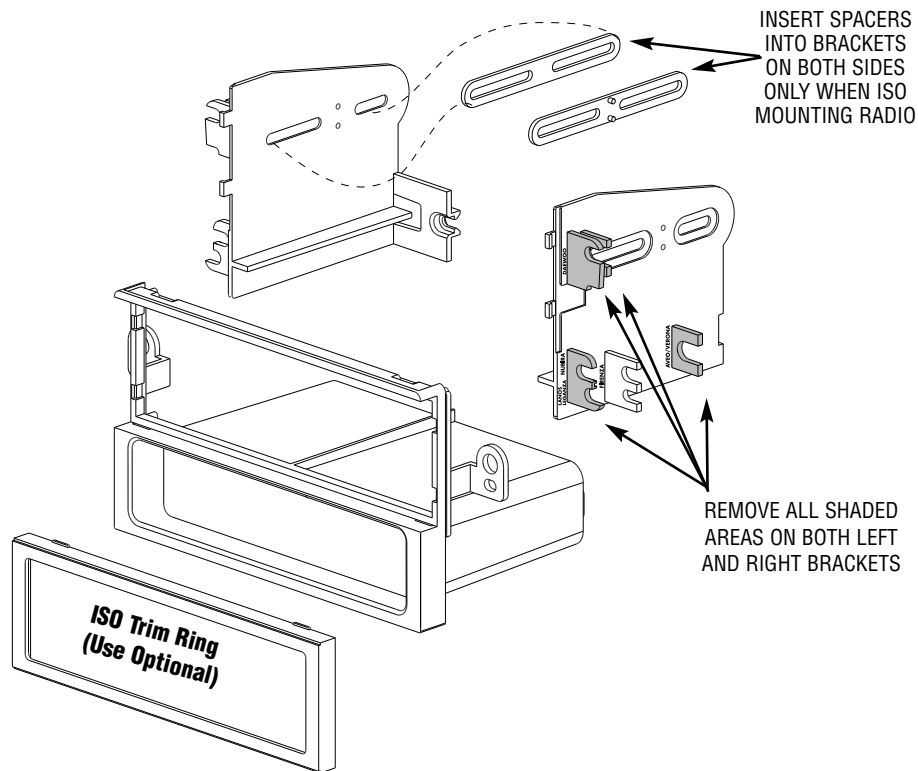

DASH DISASSEMBLY INSTRUCTIONS

1. Carefully unsnap the trim from around the radio & remove.
2. Remove the (2) Phillips screws securing the radio to the sub dash.
3. Remove the radio from the dash cavity, disconnect the wire harness & antenna lead & remove the radio.

