

KIT ASSEMBLY INSTRUCTIONS

Double DIN & Double ISO Mount Applications

- 1) Remove the Shaded tab from the back edge of each left and right mounting bracket (see Fig. B below). (Right tab not shown)
- 2) Cut and remove center rib from main bracket.
- 3) Attach the left and right side brackets to the main bracket.
- 4) Attach a rear support bracket to the rear of the radio components and adjust as needed to allow rear support bracket to rest in the sub-dash (optional).

NOTE: ISO trim ring (DITR964) must be used in place of after-market radio's trim rings. For ISO mount applications, mount after-market radio components to side brackets using screws provided with radio when possible or hardware included with kit.

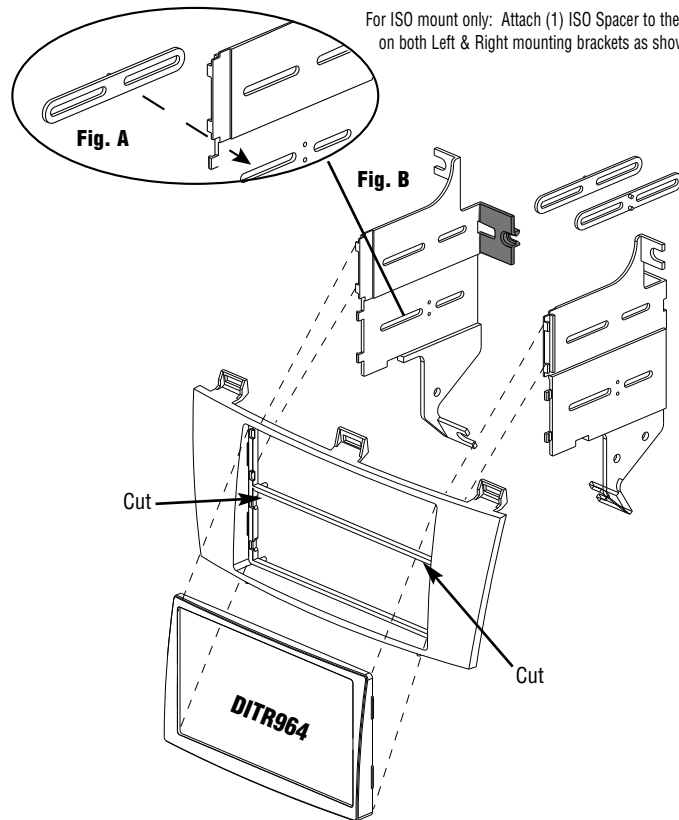

**American
International**
Car Stereo Installation Kits & Accessories

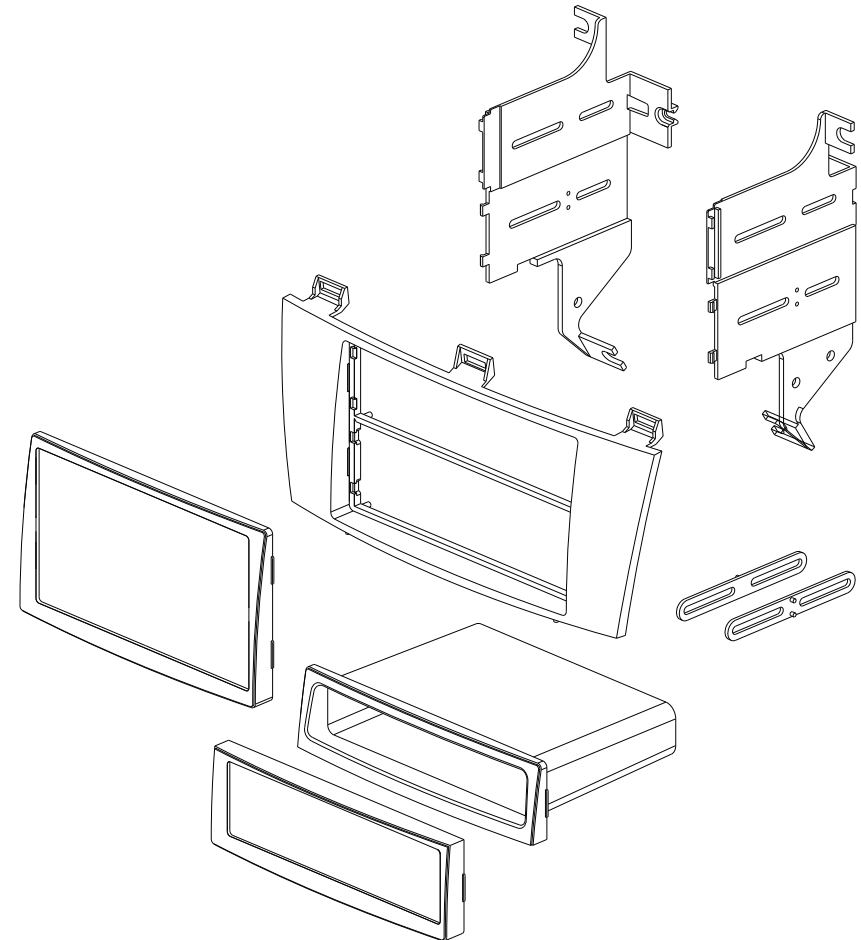

TOYK964 Mounting Kit

VEHICLE APPLICATIONS

Toyota
2004-08 SOLARA

2500 East Francis Street Ontario, CA 91761, U.S.A.
USA Sales (800) 336-6500
Canada Sales (888) 922-3006 • USA Fax (805) 388-7950

CUSTOMER HELP LINE
USA 800-323-4329 • Canada 800-245-8777

iTOYK964

©2015 AMERICAN INTERNATIONAL INDUSTRIES, INC.

TECH Ver. 01/15 PRINT Ver. 01/15

DASH DISASSEMBLY INSTRUCTIONS

1. Carefully unclip and remove the top trim section of the center console w/drink holders and remove.
2. Engage the Emergency Brake.
3. Put the key in the ignition and turn to the on position (DO NOT START THE CAR!)
4. Depress the brake pedal and place the shift lever in the low position (all the way back).
5. Open the pocket below the climate controls.
6. Carefully pry pocket towards you, disconnect the harness attached to the rear of the pocket and remove pocket assembly.
7. Remove the (2) 10mm bolts securing the bottom brackets for the Radio/Climate control assembly.
8. Carefully pry the Vent assembly located above the radio (pull forward only) to disengage the clips. There are (8) clips securing the Vent assembly, (3) at the top and (3) at the bottom and (1) on each side.
9. Unfasten (carefully cut the wire tie) and disconnect the wire harnesses from the rear of the vent assembly and remove assembly.
10. Remove the (2) 10mm bolts securing the upper brackets of the Radio/Climate control assembly to the sub-dash.
11. Carefully pull Radio/Climate Control assembly forward, disconnect all harnesses and antenna lead and remove assembly.
12. Place the shift lever back in the park position and turn the key to the off position.
13. Remove the (3) Phillips screws securing the climate control assembly to the factory brackets. The (3) factory phillips screws will need to be used to attach the Climate Control unit to the TOYK964 installation kit.

KIT ASSEMBLY INSTRUCTIONS

Single DIN Mount Applications

- 1) Attach the left and right side brackets to the main bracket.
- 2) Insert pocket into upper section of the main bracket.
- 3) Attach left and right side brackets to the rear of the pocket using screws supplied with kit.
- 4) Insert DIN sleeve from your new radio into the lower section of the installation kit.
- 5) Depress the tabs from inside the sleeves opening upward, outward, and downward to secure sleeve to the installation kit.
- 6) Install radio into sleeve and lock into place.
- 7) Attach a rear support bracket to the rear of the new radio and adjust as necessary to attach to the rear support stud located on the back of the pocket using the small phillips screw supplied with kit.

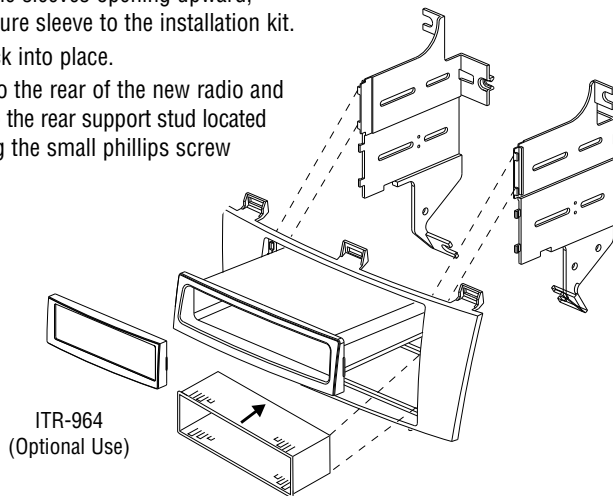

KIT ASSEMBLY INSTRUCTIONS

Single ISO Mount Applications

- 1) Attach the left and right side brackets to the main bracket.
- 2) Insert pocket into upper section of the main bracket.
- 3) Attach left and right side brackets to the rear of the pocket using screws supplied with kit.
- 4) Attach (1) ISO spacer to the inside of lower section on both Left & Right mounting brackets as shown in Fig. A.
- 5) Insert ISO mountable radio between ISO mount brackets and loosely attach to sides of radio using screws provided with radio.
- 6) Slide radio components forward or backward for desired look and tighten screws.
- 7) Attach a rear support bracket to the rear of the new radio and adjust as necessary to attach to the rear support stud located on the back of the pocket using the small phillips screw supplied with kit.

NOTE: ISO trim ring may be used in place of after-market radio's trim ring.

