

For information about other American International automotive accessories visit our website at:

<http://www.americaninternational.net>

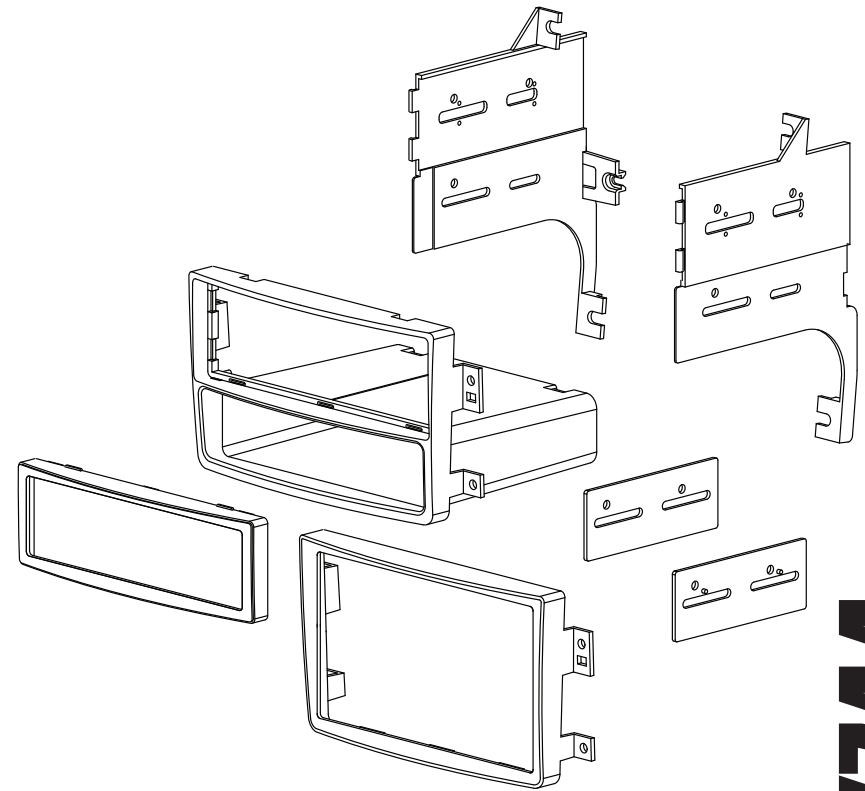

**American  
International**  
Car Stereo Installation Kits & Accessories



**NDK744 Mounting Kit**



**American International**

**Automotive Products Division**

1040 Avenida Acaso • Camarillo, CA 93012, U.S.A.

USA Sales (800) 336-6500

Canada Sales (888) 922-3006 • USA Fax (805) 388-7950

**VEHICLE APPLICATIONS**

**NISSAN**

2006-08 350 Z

**CUSTOMER HELP LINE**

**USA 800-323-4329 • Canada 800-245-8777**

iNDK744

## DASH DISASSEMBLY INSTRUCTIONS

1. Disconnect the negative battery terminal.
2. Engage the parking brake.
3. Lower the shift lever to the rear position.
4. Carefully lift up the shifter trim piece and disconnect the attached harnesses and lay out of the way.
5. Carefully lift upward and remove the climate control trim bezel.
6. Remove the (2) phillips screws securing the lower sides of the radio trim bezel edges.
7. Remove the (2) Phillips screws securing the bottom metal radio mounting brackets.
8. Remove the (2) Phillips screws securing the Climate control module located directly below the factory radio, disconnect harnesses, and carefully remove module.
9. Open the storage pocket located above the radio and remove the rubber pad from inside the pocket.
10. Using a flat blade screwdriver, lift the individual lower edge corner cap covers to reveal the individual Phillips screws from behind.
11. Remove the (2) Phillips screws inside storage pocket.
12. Carefully remove the entire Radio/Pocket/Gauge assembly forward. Disconnect all attached harnesses from rear of Radio/Gauge trim assembly and remove assembly.
13. Remove the (6) phillips screws securing the factory radio to the rear of the bezel and remove radio.

## KIT ASSEMBLY INSTRUCTIONS

### Single DIN Mount Applications

1. Attach the left and right side brackets to the main bracket. See below.
2. Using screws supplied with kit, attach pocket to left and right side brackets.
3. Insert DIN sleeve from your new radio into the upper section of the installation kit.
4. Depress the tabs from inside the sleeves opening upward, outward, and downward to secure sleeve to the installation kit.
5. Install radio into sleeve and lock into place.
6. Attach a rear support bracket to the rear of the new radio and adjust as necessary to attach to the rear support stud located on the back of the pocket using the small phillips screw supplied with kit (optional).

**NOTE:** ISO trim ring (ITR744) may be used in place of after-market radio's removable trim ring.

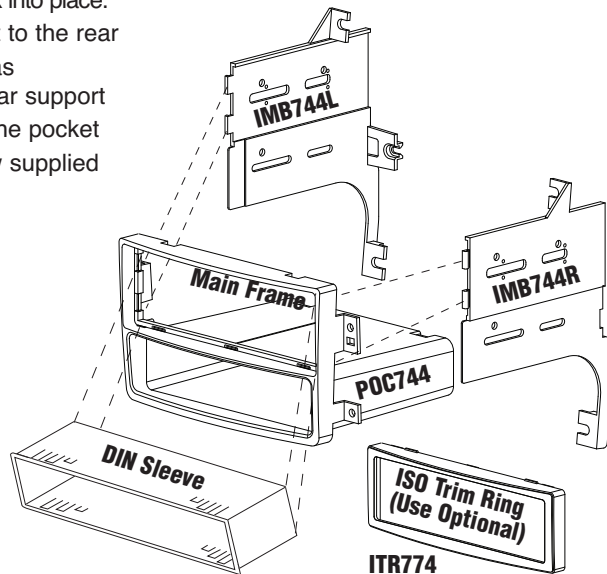

## NOTES:

---



---



---



---



---



---



---



---



---



---



---



---



---



---



---



---



---



---



---



---

**NOTES:**

---



---



---



---



---



---



---



---



---



---



---



---



---



---



---

**KIT ASSEMBLY INSTRUCTIONS**

**Single ISO Mount Applications**

1. Attach the left and right side brackets to the main bracket. See Figure B.
2. Using screws supplied with kit, attach pocket to left and right side brackets.
3. Attach (1) ISO Spacer to the inside upper section on both Left & Right mounting brackets as shown in Fig. A. (See note #2 below)
4. Insert ISO mountable radio between ISO mount brackets and loosely attach to sides of radio using screws provided with radio when possible or hardware included with kit.
5. Slide radio component forward or backward for desired look and tighten screws.
6. Attach a rear support bracket to the rear of the new radio and adjust as necessary to attach to the rear support stud located on the back of the pocket using the small phillips screw supplied with kit (optional).

**NOTE:** #1 - ISO trim ring (ITR744) may be used in place of after-market radio's removable trim ring.  
 #2 - Spacers must read upright (This side up for single ISO install).

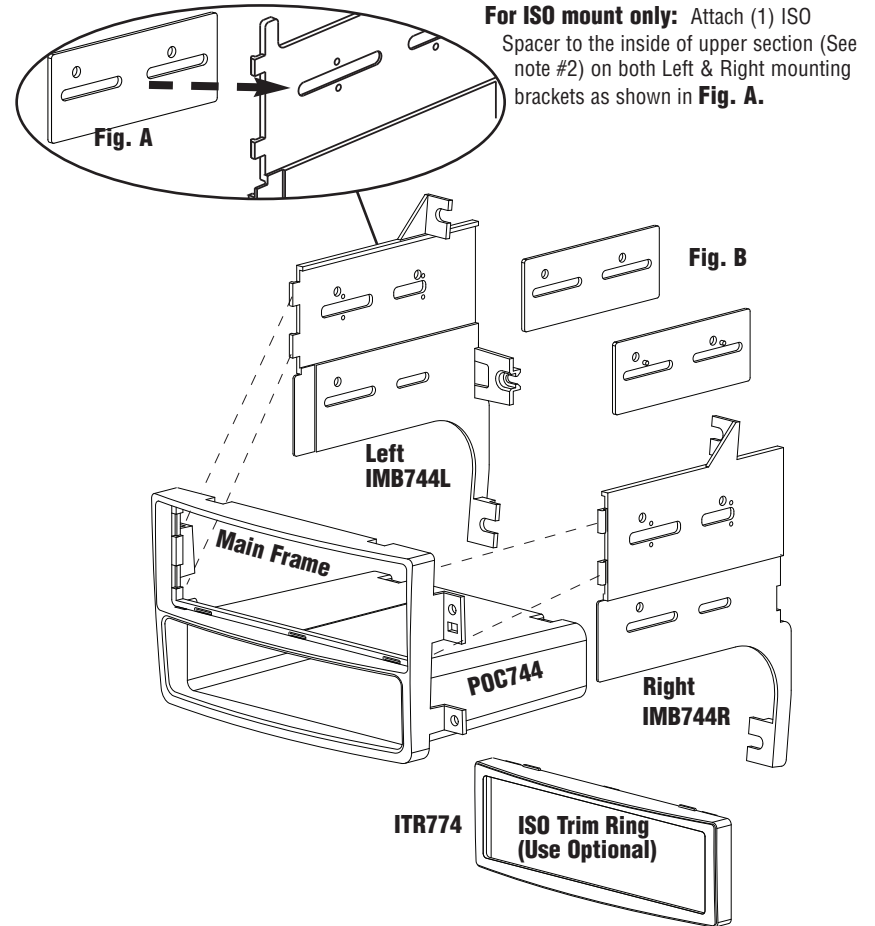

## KIT ASSEMBLY INSTRUCTIONS

### Double DIN Mount Applications

1. Remove the shaded tab on both Left and Right Brackets as illustrated below.
2. Attach (1) ISO spacer to the inside upper part on both Left and Right mounting
3. Insert ISO mountable radio between Left and Right brackets and attach radio to brackets using screws supplied with radio (when possible) or screws supplied with kit.
4. Mount radio and side brackets to factory radio bezel.  
Then place radio trim bezel back into position.
5. Attach a rear support bracket to the rear of the radio components and adjust as needed to allow rear support bracket to rest in the sub-dash (optional).

**NOTE:** #1 - ISO trim ring (DITR744) must be used in place of after-market radio's trim rings. For ISO mount applications, mount after-market radio components to side brackets using screws provided with radio when possible or hardware included with kit.

**Fig. C**

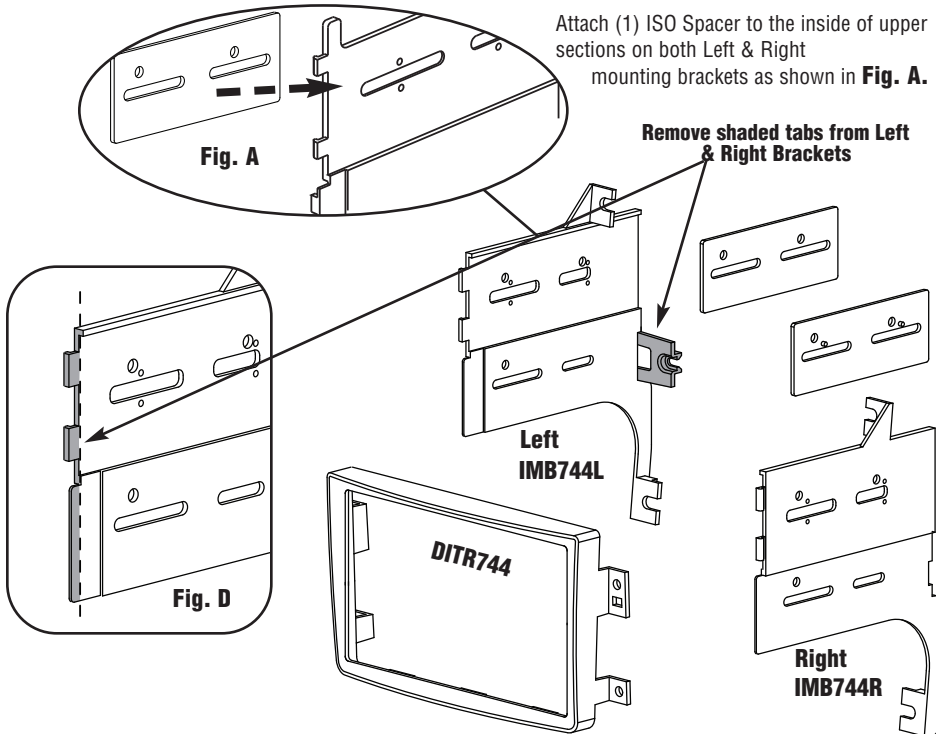

## NOTES:

---



---



---



---



---



---



---



---



---



---



---



---



---



---